

Sensori di pressione OEM per applicazioni severe

OEM pressure transmitter for heavy duty applications



- Per temperature del fluido ed ambiente fino a 125°C
- Segnali di uscita standard: 4-20mA, 0-5V, 1-5V, 0-10V, 10-90% raziometrico
- Corpo in acciaio inossidabile
- Ampia gamma di connessioni elettriche e di pressione
- Protezione elettromagnetica fino a 100V/m
- Tutte le versioni dotate di smorzatore integrato

- For media and ambient temperatures up to 125°C
- All standard output signals: 4-20mA, 0-5V, 1-5V, 0-10V, 10-90% ratiometric voltage
- Wetted parts made of stainless steel
- A wide range of pressure and electrical connections
- EMC protection up to 100 V/m
- All versions with integrated pulse-snubber

DIMENSIONS

| CONNECTOR - A | |
|---------------|-----------------------------|
| TYPE | DESCRIPTION |
| 1 | Round packard Metri-Pack |
| 2 | AMP superseal 3 pin contact |
| 3 | Deutsch DT04 |

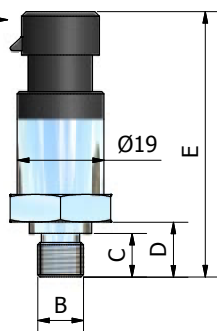

SPECIFICATIONS

| CHARACTERISTICS | VALUE |
|------------------------|------------------------------------|
| Operating temperature: | -40°C ÷ +125°C |
| Storage temperature: | -40°C ÷ +125°C |
| Power supply: | 8 ÷ 30 / 12 ÷ 30 / 5 ± 0,5 Vdc |
| Current sink: | 4,5 mA |
| Body materials: | 17-4PH |
| Stresses: | 20g, 10-2000 Hz; ref. EN 60068-2-6 |
| EMC: | 100 V/m, 26Mhz – 1Ghz |

INDICE PAG. 70

Sensori di pressione OEM con doppia uscita

OEM pressure transmitter with dual output



- Progettati per applicazioni industriali severe
- Segnali di uscita: pressione + switch; pressione + temperatura
- Per temperature del fluido ed ambiente fino a 125°C
- Ampia gamma di connessioni elettriche e di pressione
- Protezione elettromagnetica fino a 100V/m
- Marcatura CE

- Designed for use in severe industrial OEM applications
- Output signals: pressure + switch; pressure + temperature
- For medium and ambient temperature up to 125°C
- A wide range of pressure and electrical connections
- EMC protection up to 100 V/m
- CE marked

DIMENSIONS

| CONNECTOR - A | |
|---------------|-------------------|
| TYPE | DESCRIPTION |
| 1 | M12x1 EN60947-5-2 |
| 2 | Deutsch DT04 |
| 3 | DIN 72585A1-4.1 |

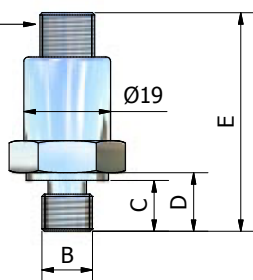

SPECIFICATIONS

| CHARACTERISTICS | VALUE |
|------------------------|------------------------------------|
| Operating temperature: | -40°C ÷ +125°C |
| Storage temperature: | -40°C ÷ +125°C |
| Power supply: | 8 ÷ 30 / 12 ÷ 30 / 5 ± 0,5 Vdc |
| Current sink: | 4,5 mA |
| Body materials: | 17-4PH |
| Stresses: | 20g, 10-2000 Hz; ref. EN 60068-2-6 |
| EMC: | 100 V/m, 26Mhz – 1Ghz |

INDICE PAG. 70